

The Barn

Block Plan 1:200

<p>Client Steven Draper</p>	<p>Project The Barn At Top O'th Quarlton Farm, Off Ramsbottom Road, Hawkshaw Road, Hawkshaw Bury, BL8 4JX</p>	<p>Drawing Site Plan (Existing)</p>	<p>Drawing No. 2017/203 Revision Scale As Noted at A3 Date Sept 2017 Drawn Harry Jackson Surveyors Unit 4a Farnworth Park Ind Est, Wellington Street, Farnworth, Bolton, BL4 7BY 01204 701740</p>
--	--	--	---

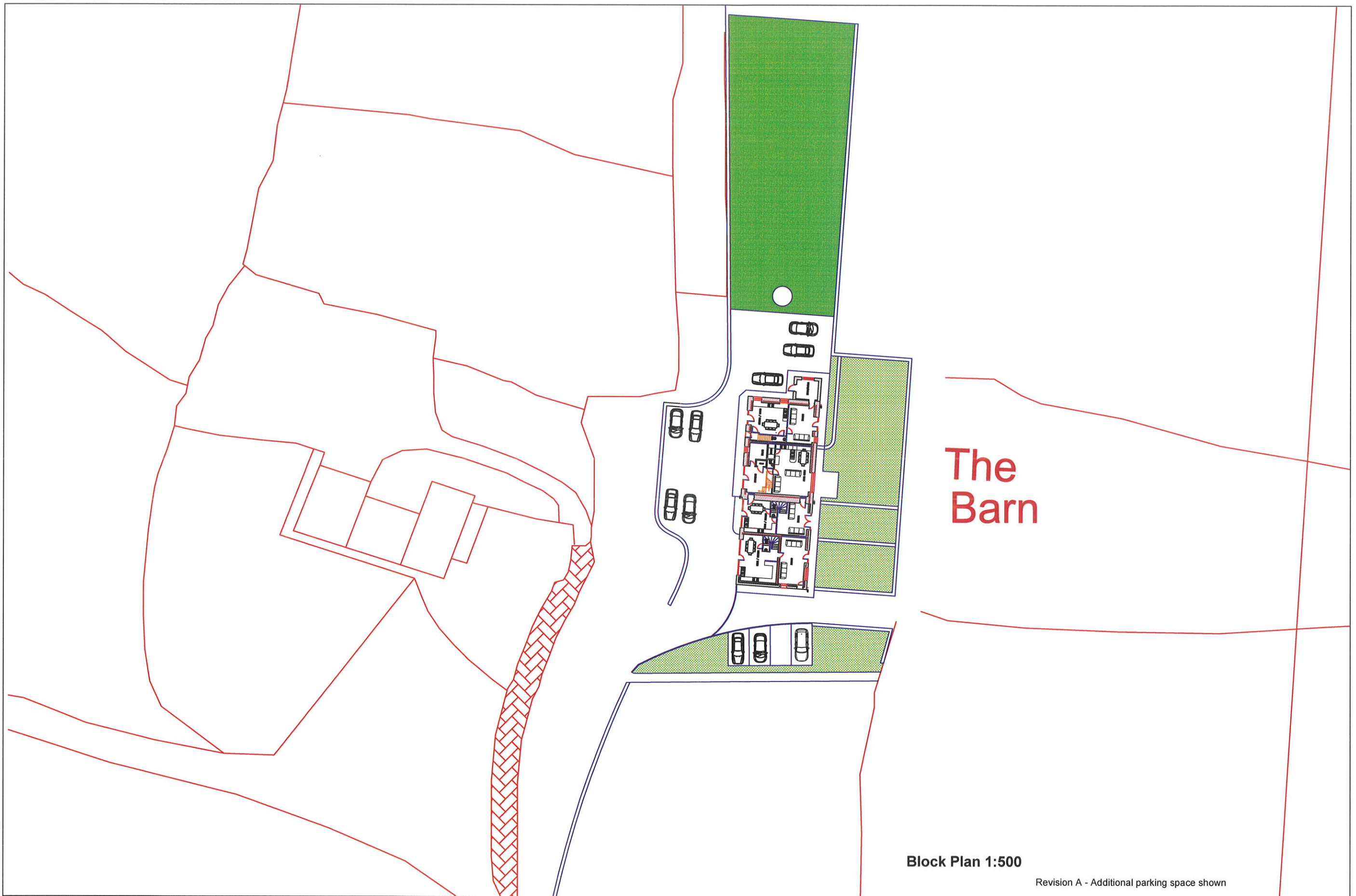

The
Barn

Block Plan 1:500

Revision A - Additional parking space shown

<p>Client Steven Draper</p>	<p>Project The Barn At Top O'th Quarlton Farm, Off Ramsbottom Road, Hawkshaw Road, Hawkshaw Bury, BL8 4JX</p>	<p>Drawing Site Plan (Proposed) (Split into 4 Dwellings)</p>	<p>Drawing No. 2017/204 Revision A Scale As Noted at A3 Date Dec 2017 Drawn Harry Jackson Surveyors Unit 4a Farnworth Park Ind Est, Wellington Street, Farnworth, Bolton, BL4 7BY 01204 701740</p>
--	--	---	--

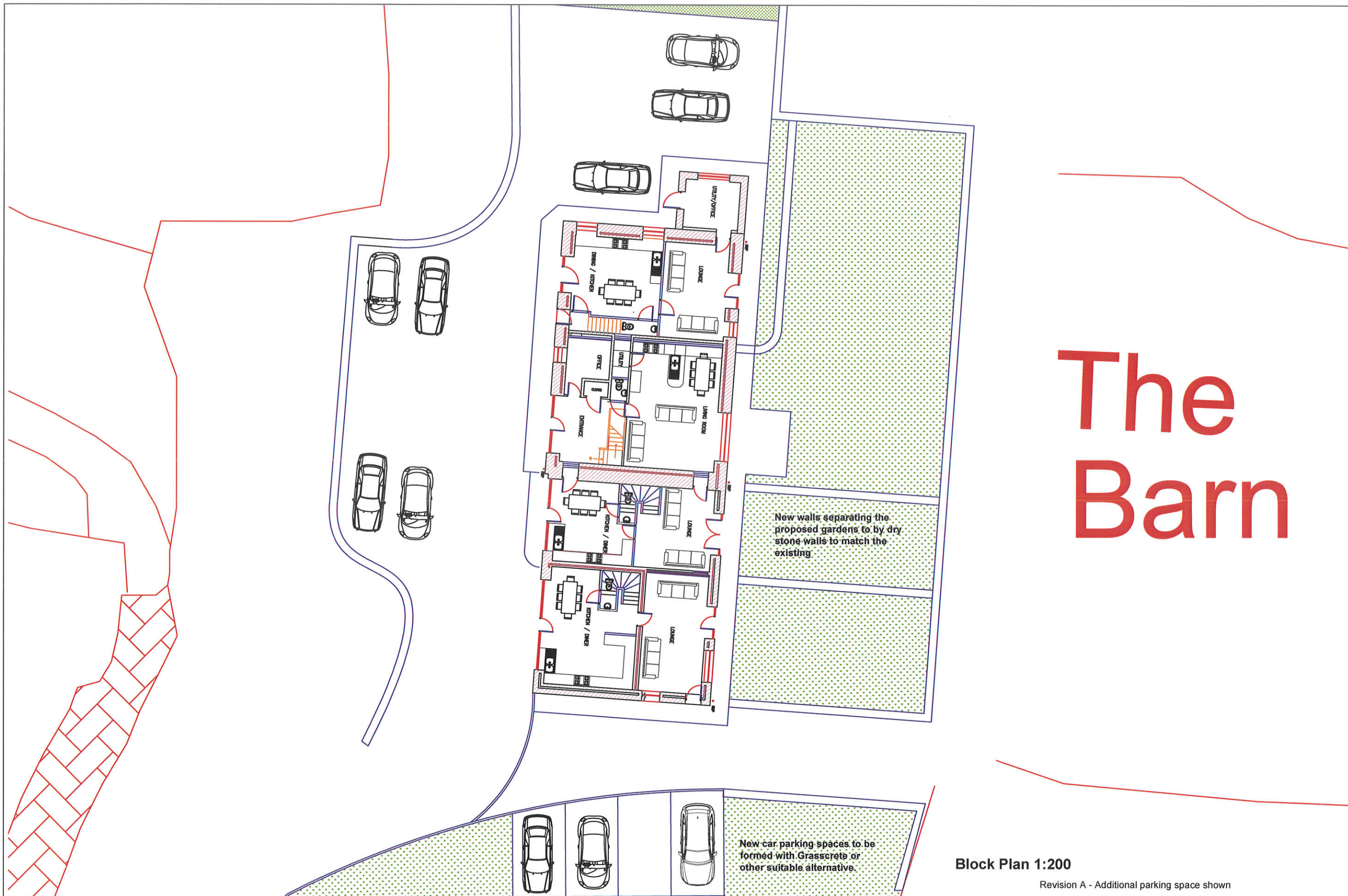

The Barn

Block Plan 1:200

Revision A - Additional parking space shown

Client
Steven Draper

Project
**The Barn At Top O'th Quarlton Farm,
Off Ramsbottom Road, Hawkshaw Road,
Hawkshaw Bury, BL8 4JX**

Drawing
**Site Plan (Proposed)
(Split into 4 Dwellings)**

Drawing No. **2017/205** Revision A
Scale As Noted at A3
Date **Dec 2017**
Drawn **Harry Jackson Surveyors**
Unit 4a Farnworth Park Ind Est, Wellington Street, Farnworth, Bolton,
BL4 7BY 01204 701740

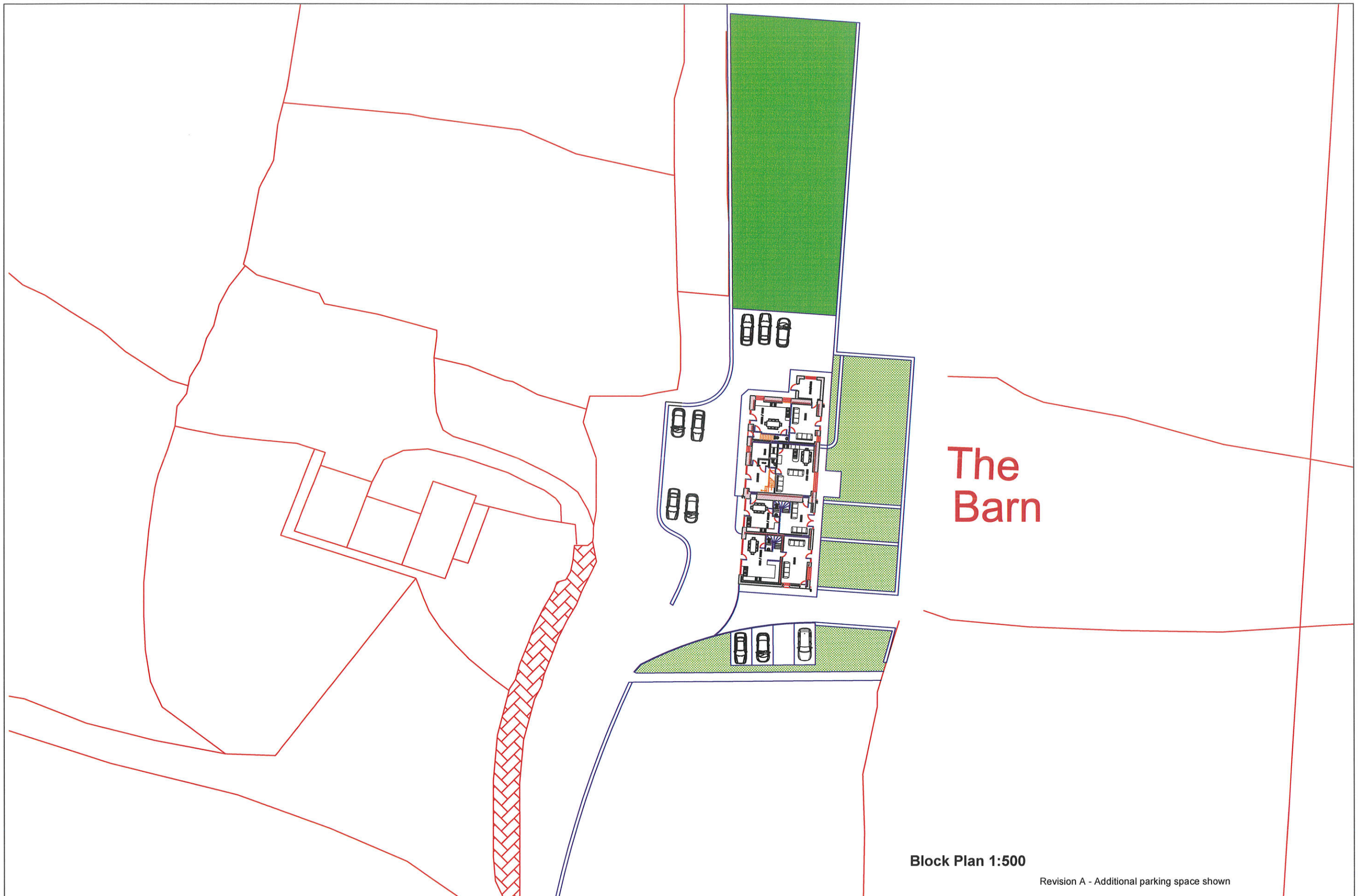

The Barn

Block Plan 1:500

Revision A - Additional parking space shown

<p>Client Steven Draper</p>	<p>Project The Barn At Top O'th Quarlton Farm, Off Ramsbottom Road, Hawkshaw Road, Hawkshaw Bury, BL8 4JX</p>	<p>Drawing Site Plan (Proposed) (Split into 4 Dwellings)</p>	<p>Drawing No. 2017/204 Revision A Scale As Noted at A3 Date Dec 2017 Drawn Harry Jackson Surveyors Unit 4a Farnworth Park Ind Est, Wellington Street, Farnworth, Bolton, BL4 7BY 01204 701740</p>
--	--	---	--

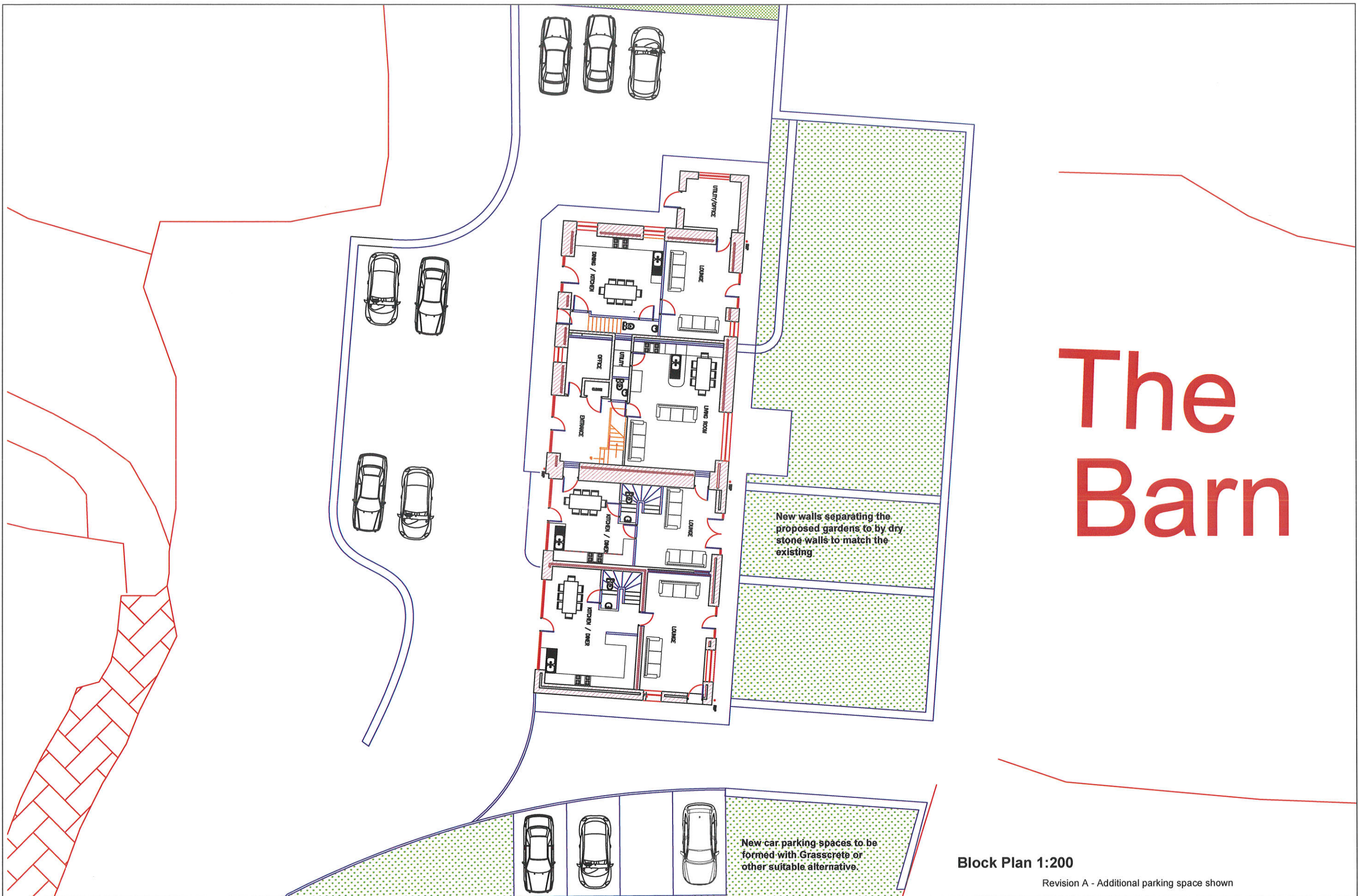

The Barn

Block Plan 1:200

Revision A - Additional parking space shown

<p>Client Steven Draper</p>	<p>Project The Barn At Top O'th Quarlton Farm, Off Ramsbottom Road, Hawkshaw Road, Hawkshaw Bury, BL8 4JX</p>	<p>Drawing Site Plan (Proposed) (Split into 4 Dwellings)</p>	<p>Drawing No. 2017/205 Revision A Scale As Noted at A3 Date Dec 2017 Drawn Harry Jackson Surveyors Unit 4a Farnworth Park Ind Est, Wellington Street, Farnworth, Bolton, BL4 7BY 01204 701740</p>
--	--	---	--